

Planning Board Meeting July 11
7 pm Town Office

Present: Duke Simoneau, Heather Quimby, Steve Littlefield, Art Hildebrandt, Roxy Hall, Dale Thomas, Steve Roache, Kathy McKavey and Mr. McKavey.

This meeting doubled as a public hearing for Steve Roache's subdivision plan. The plan is included with these notes. Is approved pending fees, letter from FEMA, and the walk through by the planning board. Motion was made by Art and seconded by Roxy. Unanimous approval.

Next we talked about land at the end of School Street. Our recommendation- against selling it and make a plan to work for the town. Make up fact sheet for informational purposes to pass out at the public meeting.

Meeting adjourned.



DEPARTMENT OF ENVIRONMENTAL PROTECTION
BUREAU OF LAND AND WATER QUALITY

FIELD DETERMINATION ID 3897

Field Determination Form

CONTACT

STEVE ROCHÉ
ROCHÉ ENTERPRISES
WEST MAIN STREET
BROOKS ME 04921
TELEPHONE (207) 722-3655

DIRECTIONS

GO WEST ON ROUTE 139 FROM BROOKS CENTER. GO ABOUT 1/2 MILE OR LESS TO DRIVE ON LEFT JUST BEFORE YELLW RANCH WITH GREEN TRIM. LAND IS OUTBACK NEXT TO THE MARSH STREAM. SITE OF OLD CHICKEN BARN.

PROPERTY OWNER

ROCHÉ, STEVE
WEST MAIN STREET

BROOKS 04921

TOWN

BROOKS

MAP

LOT

STAFF WHITTIER, VALERIE

RESOURCE RSB

MEMO

Steve plans to construct several spec houses on this lot. There is approximately 5 acres. The houses will be at least 75 feet from the river, but within the shoreland zone (250 feet) of the river.

No permit will be required pursuant to the Natural Resources Protection Act, 38 MRSA Section 480-A.

This project will require a written permit from the Town of Brooks pursuant to the Town of Brooks Shoreland Zoning Ordinance, which is consistent with the State of Maine's Manatory Shoreland Zoning Act, 38 MRSA Section 435.

Erosion control devices must be installed and maintained on the project site during any soil disturbance activity. A Maine Construction General Permit "NOI" and "NOT" must be filed with the Department if more than 1 acre of area is going to be disturbed on the project site at any given time during construction.

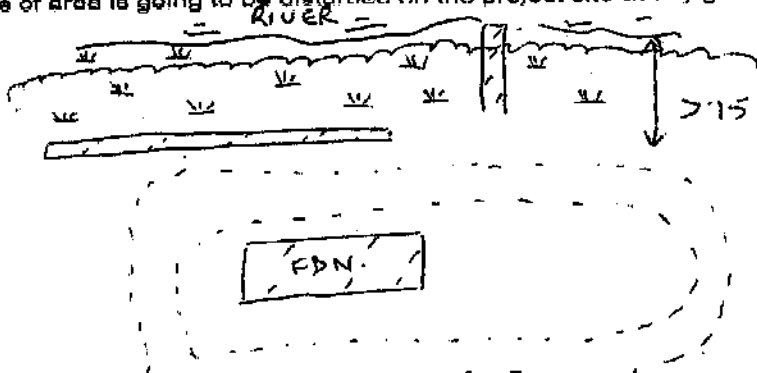

Sketch:

Name:

Valerie A. Whittier

RECEIVED 4/26/2005

SITE VISIT 5/2/2005

COMPLETED 6/6/2005

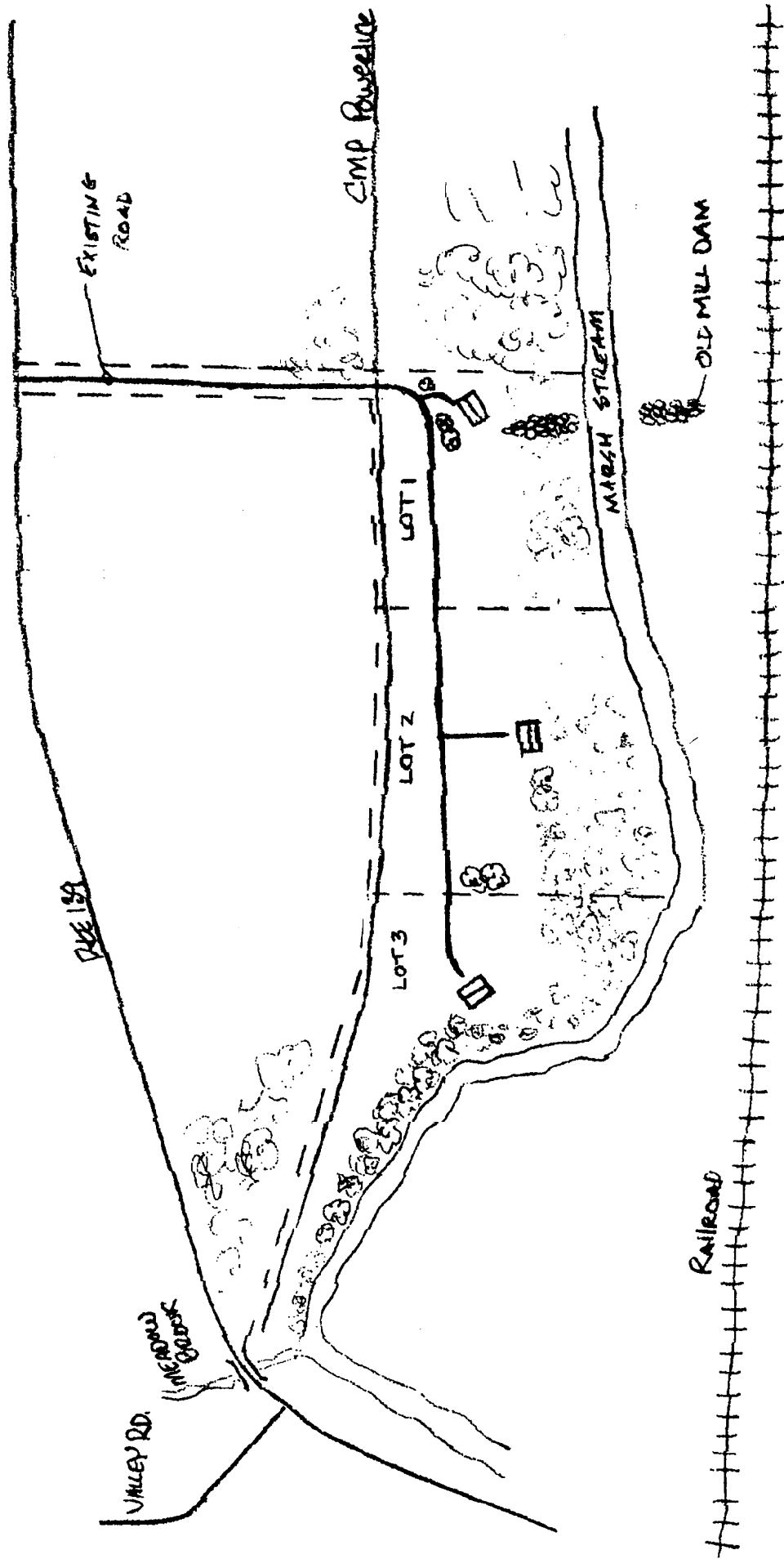

-- Proposed property lines
☉ Wooded Area